

SCALES:  
 HORIZ. 1" = 20'  
 VERT. 1" = 4'

- ☐ EXIST. W.M. TO BE RELOCATED BY OTHERS
- ☑ EXIST. GAS METER TO BE RELOCATED BY OTHERS

PARTIAL CURVE DATA  
 E Δ = 7°17'53", R = 1,367.96', L = 175.26'  
 CURB Δ = 7°19'47", R = 1,377.96', L = 176.29'  
 E Δ = 7°19'12", R = 1,417.96', L = 181.15'

CONEJO VALLEY CHURCH OF CHRIST

CONSTRUCT STREET IMPROVEMENTS PER TYPICAL SECTION ON SHEET NO. 3

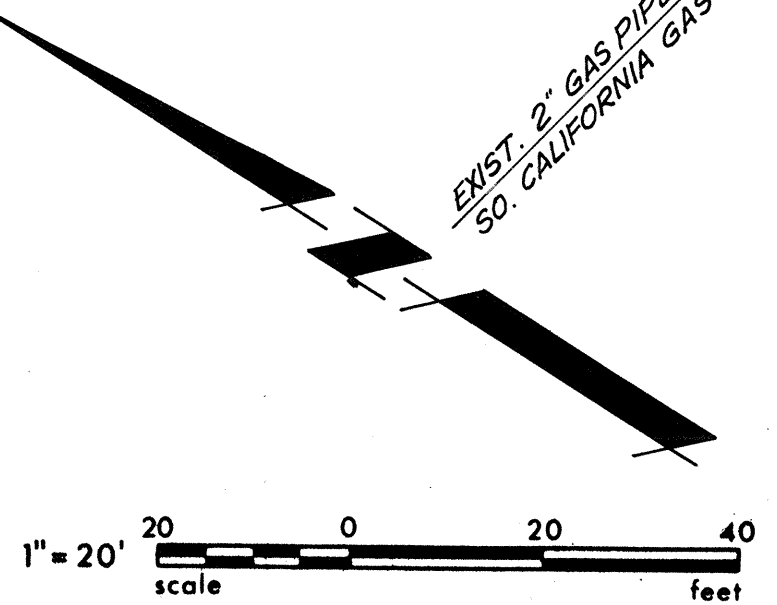
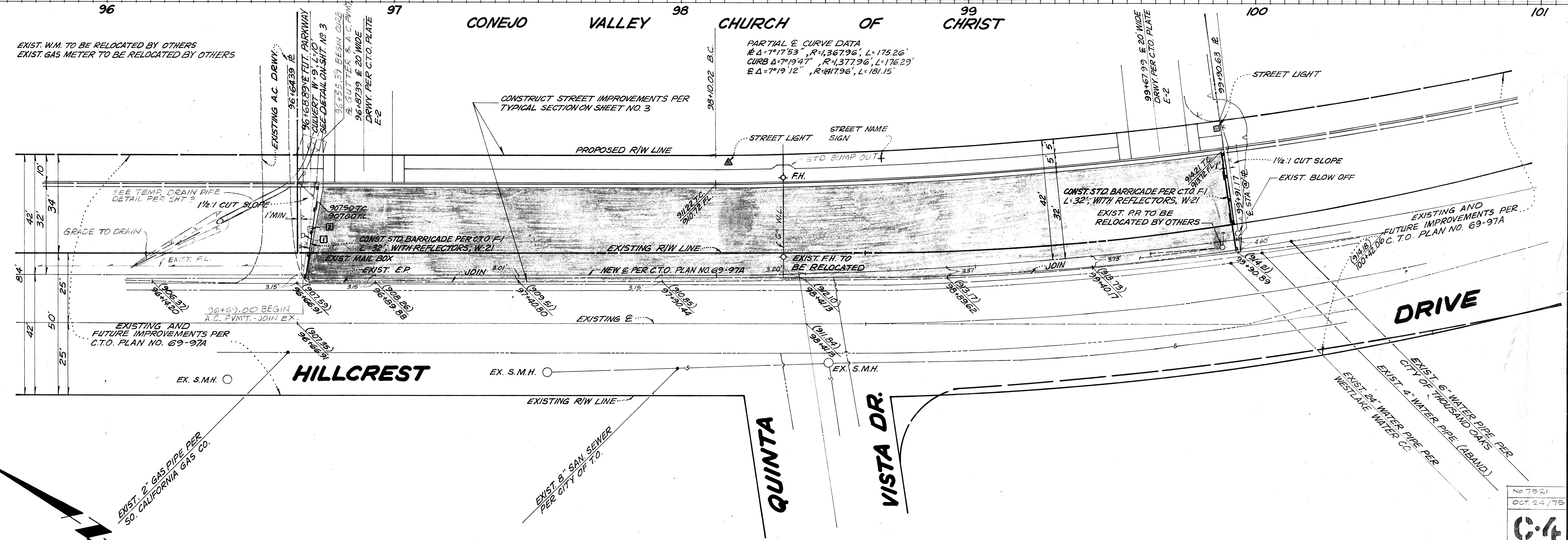

REV	SYMBOL	DESCRIPTION OF CHANGE	R.C.E.	DATE	TYP CHNG	P.D.E.	DATE

DATE	
DESIGNED	
DATE	
DELINEATED	
DATE	
CHECKED	

PREPARED BY:  
**HALE, HAALAND & ASSOC., INC.**  
 100 EAST THOUSAND OAKS BOULEVARD  
 THOUSAND OAKS PLAZA, SUITE 220  
 THOUSAND OAKS, CALIFORNIA 91360

REGISTERED CIVIL ENGINEER NUMBER 16089  
 DATE: \_\_\_\_\_  
 F. NO. \_\_\_\_\_ D. NO. \_\_\_\_\_ S. NO. \_\_\_\_\_ P. NO. \_\_\_\_\_ W.O. NO. 75-40

APPROVED BY CITY OF THOUSAND OAKS

PROJECT DEVELOPMENT ENGINEER \_\_\_\_\_ DATE \_\_\_\_\_  
 CHIEF, SUBDIVISION ENGINEERING \_\_\_\_\_ DATE \_\_\_\_\_  
 \_\_\_\_\_ DATE \_\_\_\_\_

**STREET IMPROVEMENTS**

**PLAN AND PROFILE FOR HILLCREST DRIVE**

**FROM STA. 96+64.39 TO STA. 99+91.17**

CITY OF THOUSAND OAKS PROJECT NO. SUP 73-235 SHEET 2 OF 3

No 7521  
 OCT 24 1975  
 04