

**ROOFING SPECIFICATION - CEMENT SHAKES:**

- Nailing Strips: 1" x 3 1/2" (net) at eaves, hips, rakes, intersection of roof with spire platform for insulation boundary.
- Insulation: 1" rigid fiberboard (nailed).
- Accessory Strips: 1/2" x 1" (net) redwood lath at eaves and hips (leave weep hole every 6 ft.).
- Watertight Membrane - 2 1/2:12 pitch roof surface only:
  - Felt: 2 layers No. 40 Flaxine Base Sheets (laid parallel with slope of roof).
  - Hot mopping: 25# (per square) "steep" asphalt between layers.
- Finished Roof Surface: Install cement starter shakes, standard full shakes, hip shakes and rake shakes with 30# felt, shingled between courses per manufacturer's specifications.

**ROOFING SPECIFICATION - COMPOSITION ROOFING:**

- Cant Strips: Fiber cant strips around perimeter.
- Sprinkle Mopping: 15# (per square) asphalt on plywood deck.
- Base Felt: 4 layers No. 15 perforated asbestos felt hot mopped between with 25# (per square) asphalt.
- Base Flashing (Parapet walls and other vertical surfaces): 1 Layer No. 15 asbestos base sheet and 1 layer No. 38 Double-Ply applied in asphalt.
- Protective Coating: C-13-C4 Asphalt Emulsion not less than 3 gallons per square.
- Color Coating: Sha-Kool Aluminum Coating No. 810-15 not less than 1 gallon per square (applied in 2 coats).
- Vent Pipe Flashing: Set flange in hot asphalt on first layer of base felt; nail and seal with 6" wide strip Yellow Jacket Glass Fabric.
- To conform to Class B Code.

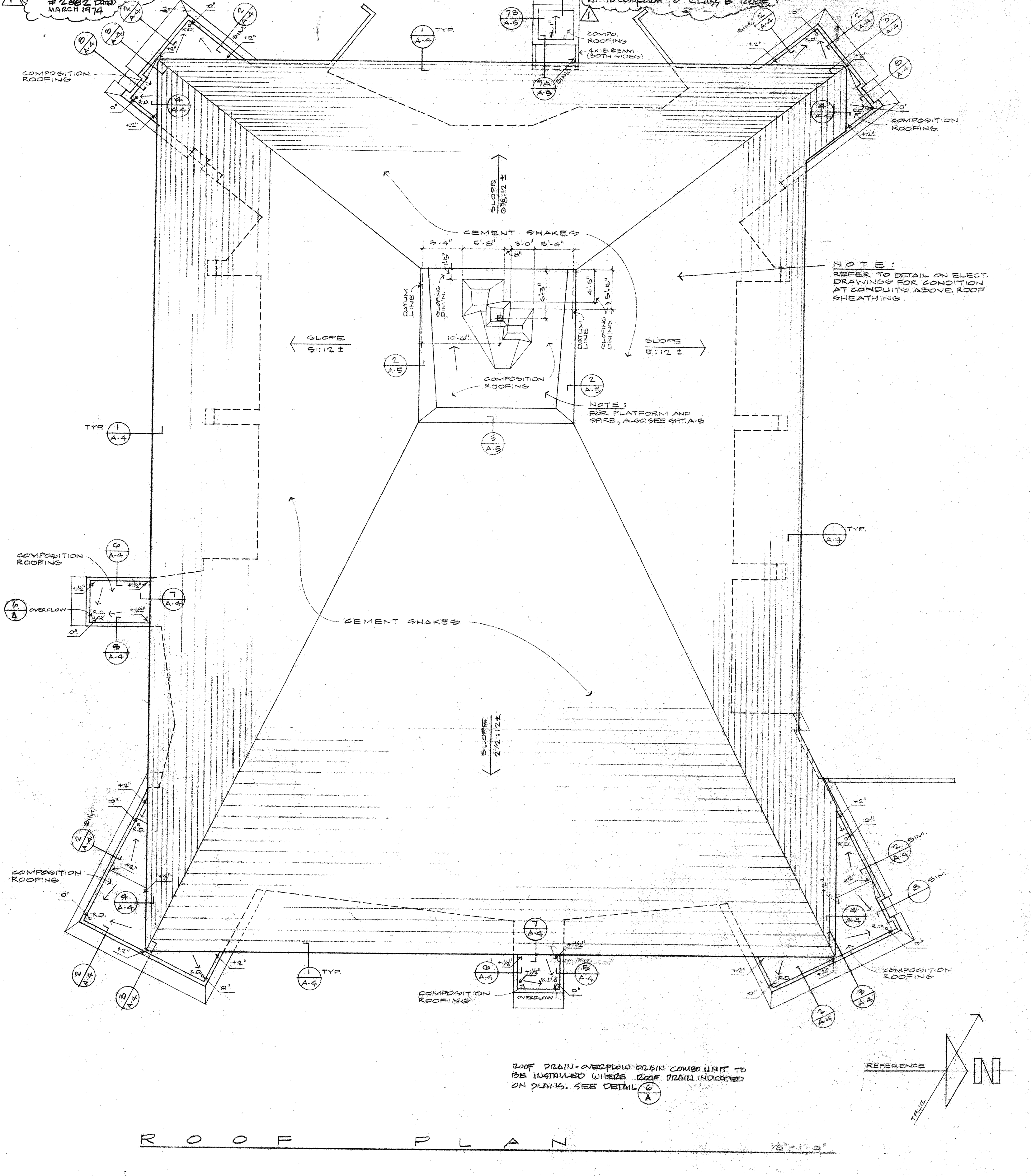

**LS LASALIA and SQUIRE AIA**  
 ARCHITECTS  
 5441 TOPANGA CANYON BLVD WOODLAND HILLS CALIFORNIA 91367  
 346-0683

REVISIONS  
 1. SEE 7/25/75  
 2. SEE 8/1/75

DETAILS  
 ROOF PLAN  
 WINDOW DETAILS

CONELLO VALLEY CHURCH OF CHRIST  
 AUXILIARY BUILDING