

GENERAL NOTES

- 1 ALL WORK ON THIS PROJECT SHALL CONFORM TO THE STANDARD LAND DEVELOPMENT SPECIFICATIONS ADOPTED BY THE CITY COUNCIL AS OF THE DATE OF APPROVAL OF THIS PROJECT OR THE DATE THAT TIME EXTENSIONS, TO SAID APPROVAL ARE GRANTED.
2 STREET NAME SIGNS SHALL BE INSTALLED BY THE DEVELOPER AS FOLLOWS: TWO FOR 4 WAY INTERSECTIONS, ONE FOR 2 WAY INTERSECTIONS (ONLY IF NAME CHANGES), TWO FOR 3 WAY INTERSECTIONS OR TO THE SATISFACTION OF THE CITY ENGINEER.
3 TRAFFIC SIGNS SHALL BE INSTALLED BY THE DEVELOPER AS SHOWN ON THIS PLAN AND AS DIRECTED BY THE CITY ENGINEER'S OFFICE.
4 ALL UNDERGROUND UTILITIES AND SERVICE LATERALS SHALL BE INSTALLED PRIOR TO CONSTRUCTION OF CURBS, GUTTERS, SIDEWALKS AND PAVING, OR AS APPROVED BY THE CONSTRUCTION INSPECTION AREA ENGINEER.
5 ALL GRADING SHALL BE IN ACCORDANCE WITH TITLE 7, CHAPTER 3 OF THE CITY OF THOUSAND OAKS MUNICIPAL CODE.
6 REQUIREMENTS FOR STREET STRUCTURAL SECTION TO BE DETERMINED BY SOIL ANALYSIS AND APPROVED IN WRITING PRIOR TO PLACEMENT OF BASE MATERIALS.
7 UNLESS SHOWN OTHERWISE, STATIONING ON PLANS REFERS TO CENTERLINE STATIONING.
8 UNLESS SHOWN OTHERWISE, ALL STRUCTURAL CONCRETE SHALL BE CLASS "A" (6 SACKS). CONCRETE FOR CURBS, GUTTERS, AND SIDEWALKS SHALL BE CLASS "B" (5 SACKS).
9 WATER SYSTEM SHALL BE CONSTRUCTED IN ACCORDANCE WITH THE CITY OF THOUSAND OAKS WATER WORKS MANUAL.
10 SEPARATION OF WATER AND SEWER LINES SHALL BE IN ACCORDANCE WITH CITY ORDINANCE.
11 A PRE-CONSTRUCTION CONFERENCE OF ALL INTERESTED PARTIES SHALL BE HELD PRIOR TO ANY CONSTRUCTION, INCLUDING GRADING.
12 STABILIZATION OF SLOPES SHALL BE IN ACCORDANCE WITH CITY APPROVED METHODS (TAMPING, GRID ROLLING, PLANTING). THE SUBDIVIDER SHALL PLANT AND INSTALL SLOPE IRRIGATION ON EACH AND EVERY SLOPE, BOTH CUT AND FILL, THREE FEET OR MORE IN HEIGHT, WITH SUITABLE GRASSES, GROUND COVER, IVY OR BUSHES WHICH WILL EFFECTIVELY AID IN EROSION CONTROL. PLANTING MATERIALS AND IRRIGATION PLANS SHALL BE SUBMITTED TO AND APPROVED BY PUBLIC WORKS DEPARTMENT PRIOR TO INSTALLATION.

NOTICE

CONTRACTOR SHALL VERIFY ALL CONDITIONS AND DIMENSIONS AND SHALL REPORT ALL DISCREPANCIES TO THE ENGINEER PRIOR TO THE COMMENCEMENT OF WORK.

ABBREVIATIONS

Table with columns for Abbreviation and Description. Includes entries like A.B. AGGREGATE BASE, A.C. ASPHALTIC CONCRETE, B.C. BEGINNING OF CURVE, etc.

SPECIAL SYMBOLS

- Inters, + INTERSECTION
L LENGTH (of Arc)
Max. M.C. M.H. Misc. Mon. MAXIMUM MIDDLE OF CURVE MANHOLE MISCELLANEOUS MONUMENT
Nat. Grd. NATURAL GROUND
O.G. ORIGINAL GROUND
7000 LUMEN MERCURY VAPOR STREET LIGHT ON MARBELITE ELECTROLIER
11,000 LUMEN MERCURY VAPOR STREET LIGHT ON MARBELITE ELECTROLIER
20,000 LUMEN MERCURY VAPOR STREET LIGHT ON MARBELITE ELECTROLIER

PUBLIC UTILITY AUTHORIZATION FOR OPERATION

WATER: CITY OF THOUSAND OAKS
401 W. HILLCREST DR., THOUSAND OAKS, CALIF.
TEL. 497-8611
SEWAGE DISPOSAL: CITY OF THOUSAND OAKS
TELEPHONE: GENERAL TELEPHONE CO.
942 PAULIENE DR., NEWBURY PARK, CALIF.
TEL. 498-2186
ELECTRIC: SOUTHERN CALIFORNIA EDISON COMPANY
3589 FOOTHILL DR., THOUSAND OAKS, CALIF.
TEL. 495-0856
GAS: SOUTHERN CALIFORNIA GAS CO.
6263 TOPANGA CANYON BLVD., WOODLAND HILLS, CALIF.
TEL. (813) 883-6200

DEVELOPER: CONEJO VALLEY CHURCH OF CHRIST
NAME: P.O. BOX 726
ADDRESS: THOUSAND OAKS, CALIF.
REPRESENTATIVE:
TELEPHONE:
DEVELOPER'S ENGINEER: HALE, HAALAND & ASSOCIATES, INC.
NAME: 100 EAST THOUSAND OAKS BOULEVARD
ADDRESS: THOUSAND OAKS, CALIFORNIA 91360
REPRESENTATIVE: KURT O. REITHMAYR
TELEPHONE: 497-4554

SOILS ENGINEER: GORIAN AND ASSOCIATES
NAME: 766 LAKEFIELD RD., SUITE A
ADDRESS: WESTLAKE VILLAGE, CALIF. 91361
REPRESENTATIVE: GERRY GORIAN
TELEPHONE: 497-2109
DATES OF REPORTS:

BENCH MARK DATA: B.M. 29-418
BRONZ DISC. STAMPED 29-418 IN TOP OF CURB, ON THE EAST SIDE OF ERBES ROAD, 365' S/O HILLCREST DRIVE 5' NORTH FROM SOUTH END OF CURB.
1964 ADJUSTMENT ELEVATION = 826.782

STREET NAME SIGNS table with columns: LOCATION, STREET NAME, STREET NAME. Row 1: 96+70, HILLCREST DR., QUINTA VISTA DR.

PERMIT NUMBERS
GRADING PERMIT NO.
ROAD ENCROACHMENT PERMIT NO.
VENTURA COUNTY FLOOD CONTROL DISTRICT ENCROACHMENT PERMIT NO.
ON-SITE PAVING PERMIT NO.

BILL OF MATERIALS table with columns: ITEM NO., ITEMS, QUANTITY, UNIT.

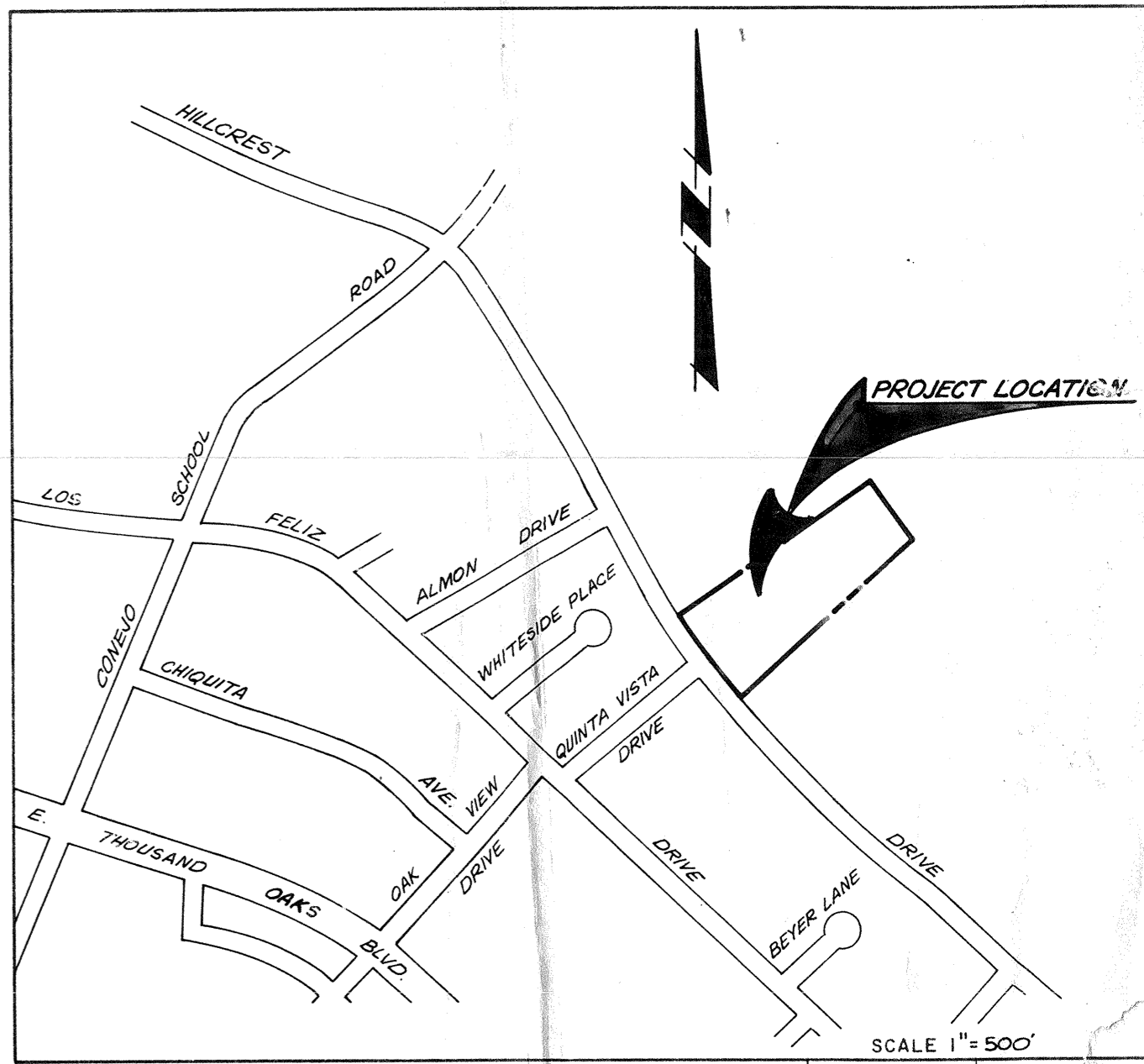

CERTIFICATE OF "AS BUILT"
I HEREBY CERTIFY THAT THE WORK ON SHEET NO'S. THROUGH MARKED AS "AS BUILT" HAVE BEEN CONSTRUCTED.
REGISTERED CIVIL ENGINEER NUMBER DATE

STANDARD COVER SHEET FOR
CITY OF THOUSAND OAKS
SUP 73-235
STREET IMPROVEMENT PLANS FOR
HILLCREST DRIVE
175 FT. N/O & 155 FT. S/O QUINTA VISTA DRIVE
SHEET 1 OF 2

INDEX OF SHEETS table with columns: NO., DESCRIPTION, CITY OF T.O. DWG. NO.
1 COVER SHEET
2 PLAN & PROFILE
3 DETAIL SHEET

Table with columns: REV, SYMBOL, DESCRIPTION OF CHANGE, R.C.E., DATE, TYPCHNG, P.D.E., DATE, CHECKED.

PREPARED BY: HALE, HAALAND & ASSOC.
100 E. THOUSAND OAKS BLVD., SUITE 220
THOUSAND OAKS, CALIF. 91360
REGISTERED ENGINEER NO. 16089 DATE

APPROVED BY CITY OF THOUSAND OAKS
PROJECT DEVELOPMENT ENGINEER DATE
DEPUTY DIRECTOR OF PUBLIC WORKS DATE
DIRECTOR OF PUBLIC WORKS DATE