

PINUS CANARIENSIS (4)

XILOEMA CONGESTUM (7)

CUPRESSOCYPARIS (6)

LEYLANDII (6)

JUNIPERIS G. 'SEA GREEN' (20)

QUERCUS ILEX (1)

AGAPANTHUS AFRICANUS (4)

PETER PAN' 1 gallon @ 18" oc.

QUERCUS ILEX (1)

ILEX WILSONII (3)

JUNIPERIS G. 'SEA GREEN' (4)

PINUS CANARIENSIS (13)

ILEX WILSONII (4)

ESCALLONIA FRAXESI (3)

JUNIPERIS G. 'SEA GREEN' (8)

QUINTA VISTA DRIVE

ILEX WILSONII (3)

QUERCUS ILEX (1)

JUNIPERIS G. 'SEA GREEN' (2)

ILEX WILSONII (3)

AGAPANTHUS AFRICANUS (4)

PETER PAN' 1 gallon @ 18" oc.

QUERCUS ILEX (2)

RAPILOLEPS INOICA (2)

CUPRESSOCYPARIS (6)

LEYLANDII (6)

XILOEMA CONGESTUM (4)

DRIVE

HILLCREST

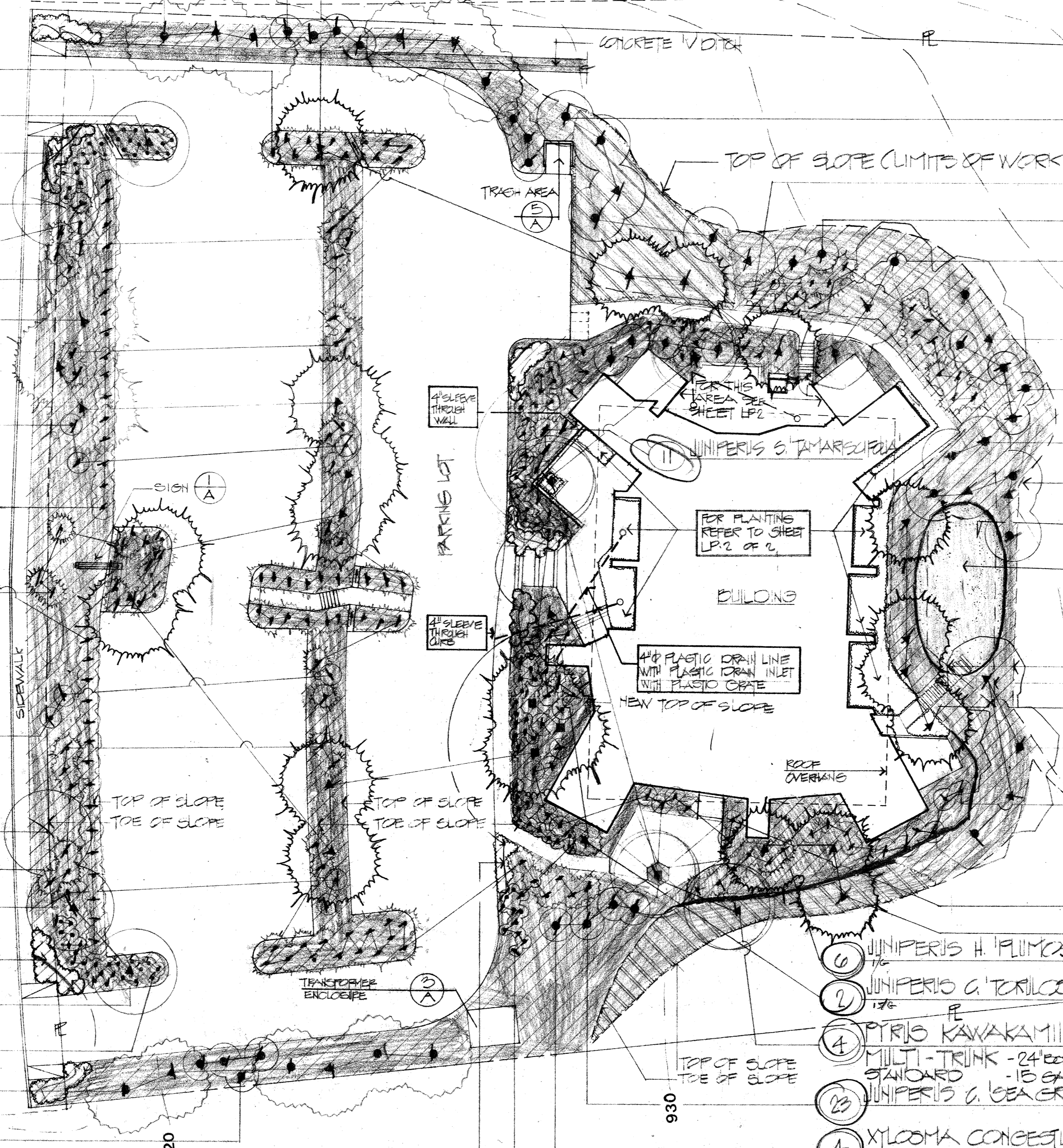

6 EUCALYPTUS SOBROXIMON (ROSEA)

13 JUNIPERIS H. 'PLUMOSA' 1/2

8 XILOEMA CONGESTUM 3/6

4 PITIOSPORUM TOBIKA VAREEATA 1/2

5 LIQUIDAMBAR STYRACIFLIA (PALO ALTO) 3-9\"/>

4 XILOEMA CONGESTUM 3/6

1 EUCALYPTUS SOBROXIMON (ROSEA) 5-9\"/>

REDWOOD HEDGES

LAWN - SEE SPECIFICATIONS FOR SEED MIX

4 PINUS CANARIENSIS

4 LIQUIDAMBAR STYRACIFLIA (PALO ALTO) 2-9\"/>

10 ESCALLONIA FRAXESI 1/2

15 PITIOSPORUM TOBIKA VAREEATA 1/2

3 PINUS CANARIENSIS 1-1/2 3-24\"/>

6 JUNIPERIS H. 'PLUMOSA' 1/2

2 JUNIPERIS G. 'TORILCOA' 1 1/2

4 PYRUS KAWAKAMII MULTI-TRUNK - 24\"/>

23 JUNIPERIS G. 'SEA GREEN' 1 1/2

4 XILOEMA CONGESTUM 3/6

51 RAPILOLEPS INOICA (SPRINGTIME)

90 AGAPANTHUS AFRICANUS (PETER PAN) 1 gallon @ 18\"/>

950

960

970

SCALE: 1" = 20'-0"

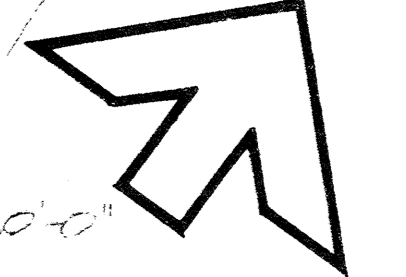

WESTLAKE VILLAGE, CA
 (805) 497-4583
 L. J. SQUIRE & ASSOCIATES
 L. J. SQUIRE
 L. J. SQUIRE
 L. J. SQUIRE

FOR APPELLABLE
 DETAILS, LEGENDS
 AND NOTES, REFER
 TO THE SPECIFICATIONS.